

BURIAL REPORT

From Sexton to Secretary of Cemetery

(TO BE RECORDED IN CEMETERY RECORD)

Burial or Permit No. 841

Sec. 2347. RECORD OF BURIALS TO BE KEPT. The record-keeping officer of every cemetery shall make and keep a permanent record of all burials, disposals, disinterments, or reburials made in such cemetery, which record shall at all times be open to public inspection. This record shall, in each case, state the name of each deceased person, place of death, date of burial, disposal, disinterment or reburial, and name and address of the undertaker.

1. Place of Death Page Shenandoah Hand Hospital
(County) (Township, Village or City) (Hospital)

2. Full name Infant Daughter of Chester Thompson

3. Sex Female 4. Color or Race white

5. Single, Married, Widowed or Divorced —

6. Date of Birth July 19, 1930 7. Age: — Years, — Months, 4 hours Days

8. Occupation —

9. Birthplace (State or Country) Iowa

10. Name of Father Chester Thompson

11. Birthplace of Father (State or Country) Iowa

12. Maiden Name of Mother Ina Pinkley

13. Birthplace of Mother (State or Country) Nebr

14. Informant Chester Thompson Address Shenandoah Iowa

16. Date of Death July 19, 1930

17. Cause of Death Brain Delivery

Name of Doctor (or Coroner or Health Officer) W. F. Stodler
Address Shenandoah, Iowa

19. Place of Burial or Removal Shenandoah, Iowa Date of Burial July 20, 1930

20. Undertaker Car Buntz Address Shenandoah, Iowa

BURIAL REPORT

No. 841

Name Baby Thompson

Filed July 20 1930

C. E. Buntz

BURIAL REPORT
From Section to Secretary of Cemetery
(To be recorded in cemetery records)

These blanks, which comply with the Iowa law, are carried in stock and sold at moderate prices by the undersigned.

The records, in which the law states these reports shall be registered, are kept in stock to fit any cemetery, and will be sent on approval to any cemetery officer.

MATT PARROTT & SONS CO.,
Waterloo, Iowa.

MATT PARROTT & SONS CO., WATERLOO, IOWA A98088

Field Record of Previous Burials

These sheets to be used on the grounds to secure data which will be copied permanently in Cemetery Lot Record.

NOTE: Each small square represents a square foot of lot surface. For convenience each tenth foot is indicated by a heavy line. To make a record of previous burials, draw a diagram, with pencil, of each lot, beginning with Lot No. 1, and use a separate sheet for each lot. This can be done in the office from the plat and the owner's name and other data as to ownership secured from deed record. These blanks will then be taken to the cemetery and a record will be made from the lots, of the names of those buried and location of grave on lot. A number corresponding to name must be placed on plat to identify grave.

Description Owned 1/2 lot 2nd add., Block 9., 1/2 Lot No. 9., 16x14. Ft.
Addition, Sub-division or Section Part of Lot Dimensions
Name of Owner Clifford Thompson Address Shenandoah. Date Sold July 19, 1930
Remarks: Lot 9200 P. base \$25.00 July 20, 1930 Price, \$57.00

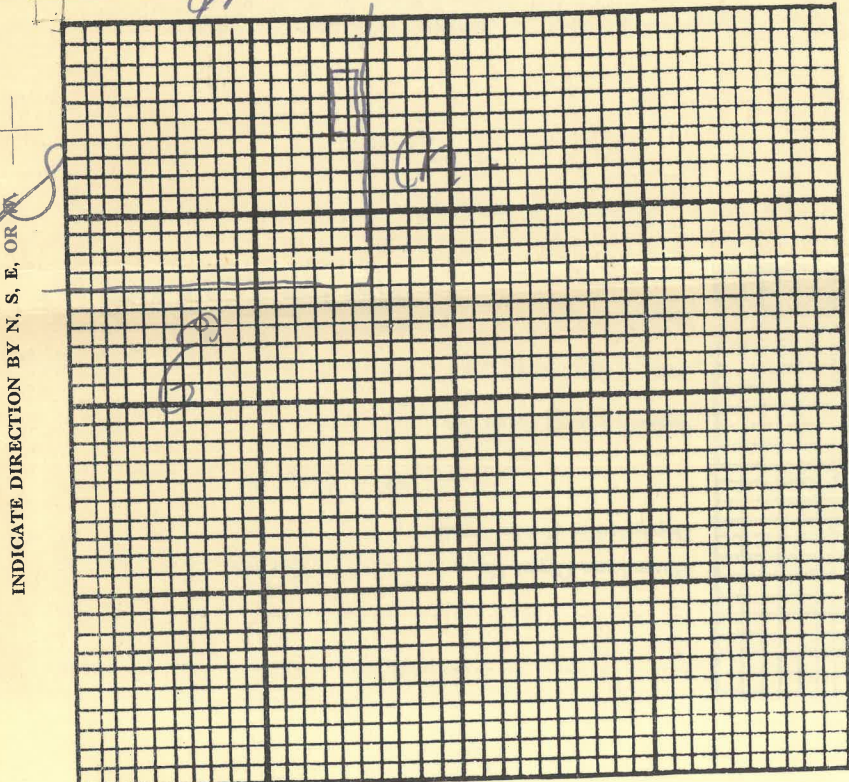

Grave No.	FULL NAME OF DECEASED	REMARKS
1	Baby Thompson	
2	Grave is 2 1/2 ft from West	
3	lot line 1 1/2 ft from N.W.	
4	corner to center of grave	
5	Digging grave \$35.00	
6		
7	Buntz	
8		
9	Will make payments	
10		
11		
12		

INDICATE DIRECTION BY N, S, E, OR W