

NOTE: Each small square represents a square foot of lot surface. For convenience each tenth foot is indicated by a heavy line. To make a record of previous burials, draw a diagram, with pencil, of each lot, beginning with Lot No. 1, and use a separate sheet for each lot. This can be done in the office from the plat and the owner's name and other data as to ownership secured from deed record. These blanks will then be taken to the cemetery and a record will be made from the lots, of the names of those buried and location of grave on lot. A number corresponding to name must be placed on plat to identify grave.

Description Owned 1/2 lot 42 add., Block 42, 1/2 Lot No. 7, 16x14 Ft. Dimensions

Name of Owner Mr. John Todd Address Shenandoah Date Sold July 12, 1943

Remarks: 92.00 P. Car 25.00 July 13, 1943 Price, \$ 57.00

INDICATE DIRECTION BY N, S, E, OR W.

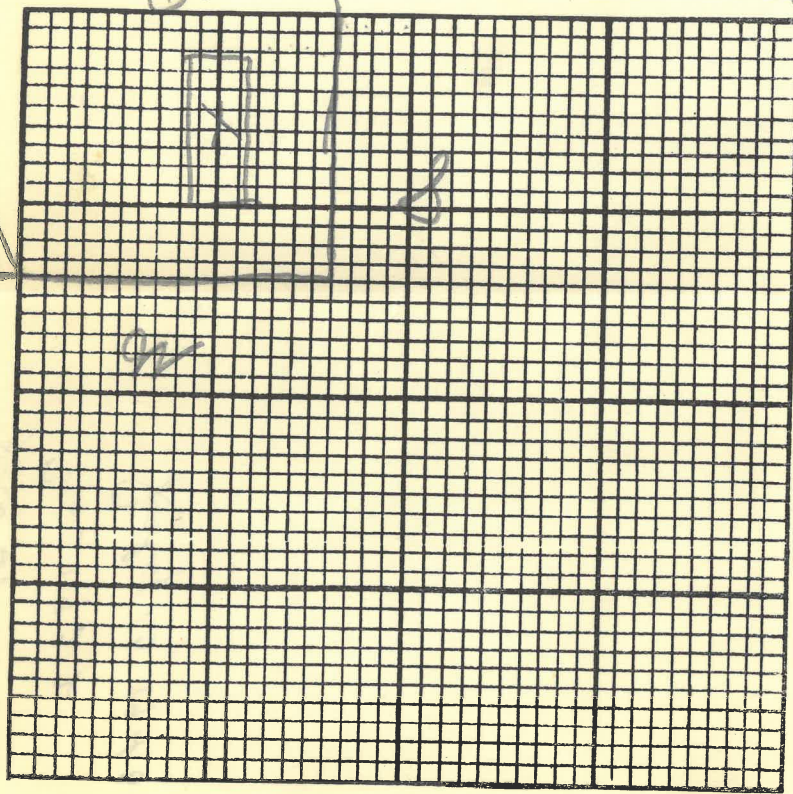

Grave No.	FULL NAME OF DECEASED	REMARKS
1	John Todd.	
2	Grave is 2 1/2 ft from	
3	East lot line 1 ft	
4	from South lot line	
5	to center of grave.	
6	Digging vault \$12.00	
7		
8		
9		
10	Carson of Essex.	
11		
12	P-69 <sup>10</sup> rec # 7612. 7-12/43	

V. S. No. 161-7-41-15M

County Polk  
 Township Valley  
 City West Des Moines

IOWA

STATE DEPARTMENT OF HEALTH  
 DIVISION OF VITAL STATISTICS

Permit No. 40  
 Reg. Dist. No. 77-6

**BURIAL, REMOVAL OR CREMATION PERMIT**

Full Name John William Todd Age 72 Sex Male Color White  
 Cause of death Carcinoma Liver Date of death July 10, 1943  
 Place of burial, removal or cremation Burial Via Auto  
 Physician Dr. Fred Starnagel Address West Des Moines Ia  
 Funeral Director W. O. Carson Address Essex, Iowa

A certificate of death having been filed in my office in accordance with the laws of Iowa, I hereby authorize the Burial of the body of said deceased person as stated above.

Dated 19 43 Local Registrar Helen G. Galt 77-6  
 Address West Des Moines Ia

Burial permit MUST be delivered by the funeral director to the superintendent or other persons in charge of the burial ground or cemetery where burial takes place. When the body is to be shipped to a point requiring the service of a common carrier do not use this form but ship on transportation of corpse permit as required by the State Department of Health. For full particulars see rules and regulations governing the transportation of dead bodies.

Superintendent's Signature John Baldwin Date of interment July 13, 1943  
 This permit must be indorsed by the superintendent and given to the Local Registrar of the district in which the cemetery is located within ten days after interment.