

BURIAL REPORT
From Sexton to Secretary of Cemetery
(TO BE RECORDED IN CEMETERY RECORD)

Burial or Permit No.....

1. Place of Death Pottawattamie Council Bluffs Jennie Edmundson
(County) (Township or City) (Facility)
2. Name: Linda Carol Geer
3. Sex: feale 4. Color or Race: Caucasian
5. Single, Married, Widowed, or divorced: Widowed
6. Date of Birth 3/21/1950 7. Age 70 Years Months Days
8. Occupation: CNA
9. Birthplace (State or County) Shenandoah, IA
10. Name of Father: Tully Mutchler
11. Birthplace of Father:
12. Maiden Name of Mother: Mabel Cummins
13. Birthplace of Mother:
14. Informant: Jill Vasquez Address: 336 W 4th St; Boone, IA 50036
16. Date of Death: Aug 16, 2020
17. Name of Doctor (or Coroner or Health Officer): Dr. Goswami
19. Place of Burial or Removal Rose Hill Cemetery 20. Date of Burial: 08/29/2020
21. Undertaker Hackett Livingston Funeral Home
22. Address 208 W. Clarinda Ave. Shenandoah, Iowa 51601

BURIAL REPORT

\$ 450.00

No. 8547

Name: Linda Geer

Burial Date: 8/29/2020

Date of Death 8/16/2020

Cam 1

Field Record of Previous Burials

These sheets to be used on the grounds to secure data which will be copied permanently in Cemetery Lot Record.

NOTE: Each small square represents a square foot of lot surface. For convenience each tenth foot is indicated by a heavy line. To make a record of previous burials, draw a diagram, with pencil, of each lot, beginning with Lot No. 1, and use a separate sheet for each lot. This can be done in the office from the plat and the owner's name and other data as to ownership secured from deed record. These blanks will then be taken to the cemetery and a record will be made from the lots, of the names of those buried and location of grave on lot. A number corresponding to name must be placed on plat to identify grave.

Description Owned 1st Add., Block 1, N 1/2 Part of Lot No. 2, _____ Ft.
Addition, Sub-division or Section Part of Lot Dimensions

Name of Owner Geer Address _____ Date Sold _____

Remarks: Concrete Vault Price, \$ _____

211

INDICATE DIRECTION BY N. S. E. OR W.

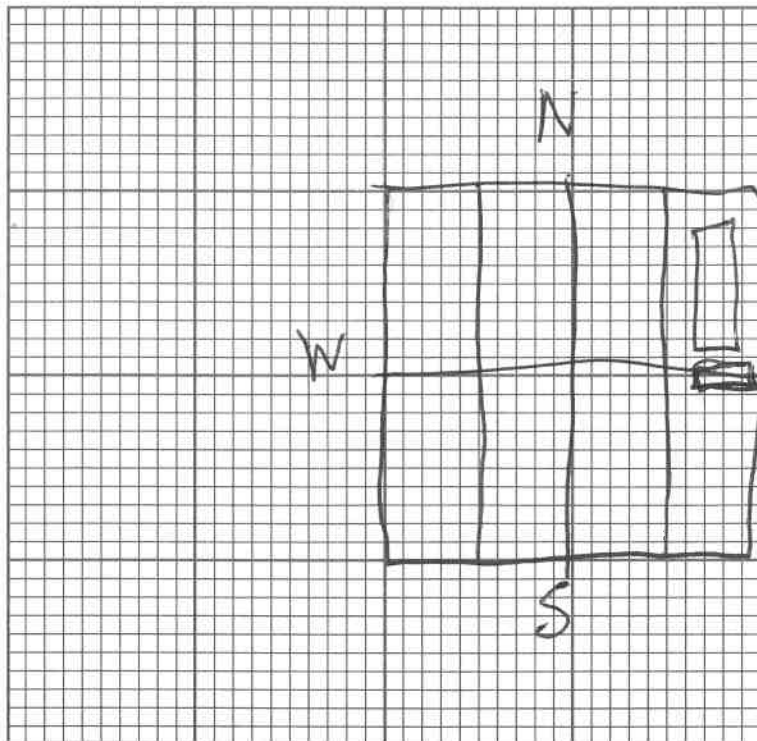

Grave No.	FULL NAME OF DECEASED	REMARKS
1	Linda Geer	
2		
3		2" from E lot line
4		in N 1/2 to center of
5		grave.
6		2'6" from S lot
7		line to edge of grave
8		
9		
10	Hackett	
11	8-29-20	
12		