

# Burial Report

From Sexton to Secretary of Cemetery  
(To BE RECORDED IN CEMETERY RECORD)

Burial or Permit No. 8279 ©

1. Name Paul Edward Duncan Birthdate August 5th, 1928 Age 87
2. Date of Death January 21st, 2016 Coroner Dr. Michael Towbin M.D
3. Place of Death Larimer Loveland, CO Pathways Hospice  
(County) (Township or City) (Facility)
4. Birthplace (State or County) Oklahoma
5. Sex male Ethnicity White
6. Marital Status Widowed
7. Occupation Repairman
8. Name Father \_\_\_\_\_ Birthplace \_\_\_\_\_
9. (Maiden) Name Mother Mildred Trudeau Birthplace unknown
10. Informant Rebecca Velarde Address 1005 Cynthia Ct. Loveland CO 80637
11. Place of Burial Rose Hill Cemetery Date of Burial \_\_\_\_\_
12. Undertaker private service Address \_\_\_\_\_

# BURIAL REPORT

No. 8879

Name Paul Edward Duncan

Burial Date June 24th, 2016

Date of Death January 21st, 2016

## Field Record of Previous Burials

*These sheets to be used on the grounds to secure data which will be copied permanently in Cemetery Lot Record.*

NOTE: Each small square represents a square foot of lot surface. For convenience each tenth foot is indicated by a heavy line. To make a record of previous burials, draw a diagram, with pencil, of each lot, beginning with Lot No. 1, and use a separate sheet for each lot. This can be done in the office from the plat and the owner's name and other data as to ownership secured from deed record. These blanks will then be taken to the cemetery and a record will be made from the lots, of the names of those buried and location of grave on lot. A number corresponding to name must be placed on plat to identify grave.

Description Owned Memorial, Block 3, N 1/2 Lot No. 97, \_\_\_\_\_ Ft.  
Addition, Sub-division or Section Part of Lot Dimensions

Name of Owner Duncan Address \_\_\_\_\_ Date Sold \_\_\_\_\_

Remarks: cremation Price, \$ \_\_\_\_\_

37

INDICATE DIRECTION BY N. S. E. OR W.

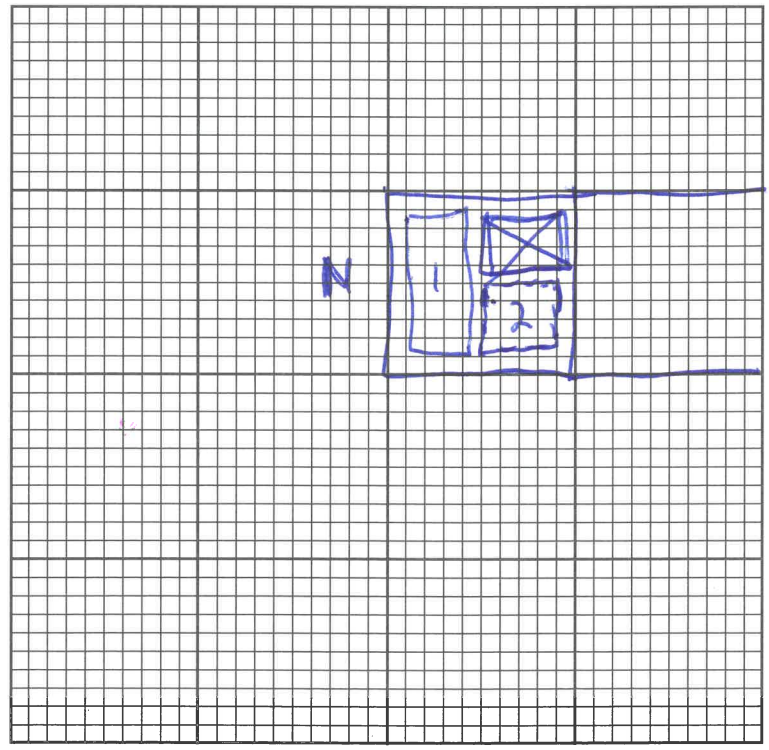

Grave No.	FULL NAME OF DECEASED	REMARKS
1		
2	Paul Duncan	
3		
4		5'6" from W lot line to center of grave
5		
6		
7		6 ft. from W line to edge of grave
8		
9		
10	Burial June 24, 2016	
11		
12	Family Service	