

Burial Report

From Sexton to Secretary of Cemetery
(To BE RECORDED IN CEMETERY RECORD)

Burial or Permit No. **8375 V**.....

1. Name Harriet Anne Buttry Birthdate 12/01/1926 Age 92
2. Date of Death 02/02/2018 Coroner unknown
3. Place of Death Jackson Lee Summit, MO
(County) (Township or City) (Facility)
4. Birthplace (State or County) Downer Grove, IL
5. Sex Female Ethnicity caucasian
6. Marital Status widow [Lucas Wayne Buttry]
7. Occupation Pastor
8. Name Father Frank Arnold Birthplace unknown
9. (Maiden) Name Mother Francena Arnold [maiden unknown] Birthplace unknown
10. Informant unknown Address unknown
11. Place of Burial Rose Hill Cemetery Date of Burial 03/03/2018
12. Undertaker Langsford Funeral Home Address Lee Summit, MO

BURIAL REPORT

No. 8375 v

Name Harriett Anne Buttry [F]

Burial Date 03/03/2018

Date of Death 02/02/2018

Field Record of Previous Burials

These sheets to be used on the grounds to secure data which will be copied permanently in Cemetery Lot Record.

NOTE: Each small square represents a square foot of lot surface. For convenience each tenth foot is indicated by a heavy line. To make a record of previous burials, draw a diagram, with pencil, of each lot, beginning with Lot No. 1, and use a separate sheet for each lot. This can be done in the office from the plat and the owner's name and other data as to ownership secured from deed record. These blanks will then be taken to the cemetery and a record will be made from the lots, of the names of those buried and location of grave on lot. A number corresponding to name must be placed on plat to identify grave.

Description Owned Southview, Block 1, E $\frac{1}{2}$ Lot No. 88, _____ Ft.
Addition, Sub-division of Section Part of Lot Dimensions

Name of Owner Buttry Address _____ Date Sold 1978

Remarks: Concrete Vault Price, \$ _____

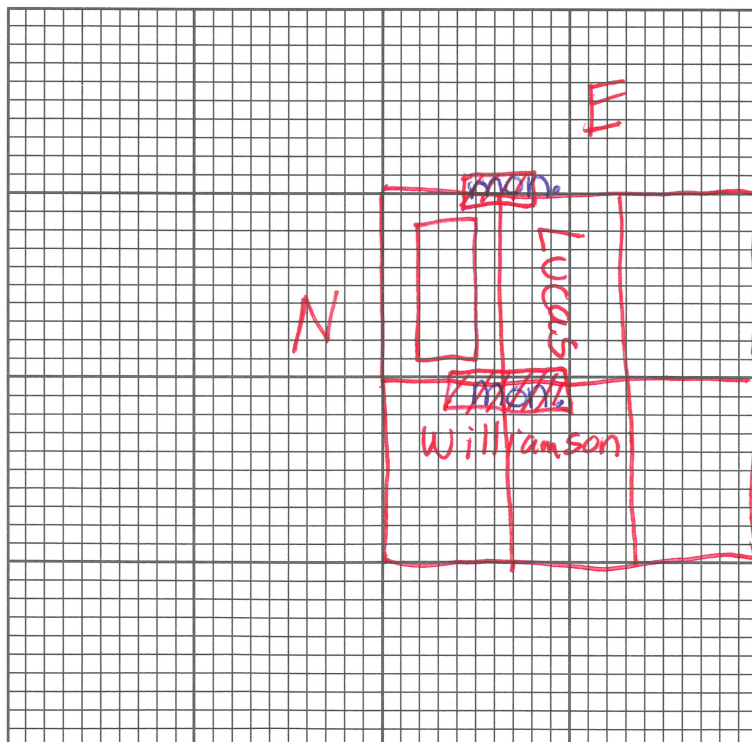

Grave No.	FULL NAME OF DECEASED	REMARKS
1	Harriett Buttry	
2		
3		2' from the E lot
4		line to the edge of
5		grave.
6		2' from N lot line
7		in E $\frac{1}{2}$ to center of
8		grave.
9		
10		
11	Langford	
12	3/3/18	

INDICATE DIRECTION BY N, S, E, OR W.