

# BURIAL REPORT

From Sexton to Secretary of Cemetery  
(TO BE RECORDED IN CEMETERY RECORD)

8384 (✓)

Burial or Permit No. ....

1. Place of Death Page Shenandoah 1203 S. Elm St.  
(County) (Township or City) (Facility)
2. Name: Marvel JoAnn Skinner
3. Sex: Female 4. Color or Race White
5. Single, Married, Widowed or Divorced Widowed
6. Date of Birth Oct. 21, 1931 7. Age 86 Years 4 Months 27 Days
8. Occupation: City Clerk - Shenandoah
9. Birthplace (State or County) Imogene - Fremont County, Iowa
10. Name of Father Joseph Edward Borimor
11. Birthplace of Father \_\_\_\_\_
12. Maiden Name of Mother Grace Evelyn Myers
13. Birthplace of Mother \_\_\_\_\_
14. Informant David Skinner 15. Address 809 S Center, Shen
16. Date of Death: March 20, 2018 - Elm Heights Care Center
  
- Name of Doctor (or Coroner or Health Officer) Dr. Donald Bumgarner, MD
- Address 1 Jack Foster Dr, Shenandoah, IA 51601
- Place of Burial or Removal Rose Hill Cemetery Date of Burial: March 23, 2018
19. Undertaker Nishna Valley F & C Address 405 W Thomas Ave, Shen

# BURIAL REPORT

\$450.00

No. 8384 ①

Name Marvel J. Skinner

Burial Date March 23, 2018

Date of Death March 20, 2018

## Field Record of Previous Burials

*These sheets to be used on the grounds to secure data which will be copied permanently in Cemetery Lot Record.*

NOTE: Each small square represents a square foot of lot surface. For convenience each tenth foot is indicated by a heavy line. To make a record of previous burials, draw a diagram, with pencil, of each lot, beginning with Lot No. 1, and use a separate sheet for each lot. This can be done in the office from the plat and the owner's name and other data as to ownership secured from deed record. These blanks will then be taken to the cemetery and a record will be made from the lots, of the names of those buried and location of grave on lot. A number corresponding to name must be placed on plat to identify grave.

Description Owned South view, Block 1, W 1/2 Lot No. 95, \_\_\_\_\_ Ft.  
Addition, Sub-division or Section Part of Lot Dimensions

Name of Owner Skinner Address \_\_\_\_\_ Date Sold \_\_\_\_\_

Remarks: Vault Price, \$ \_\_\_\_\_

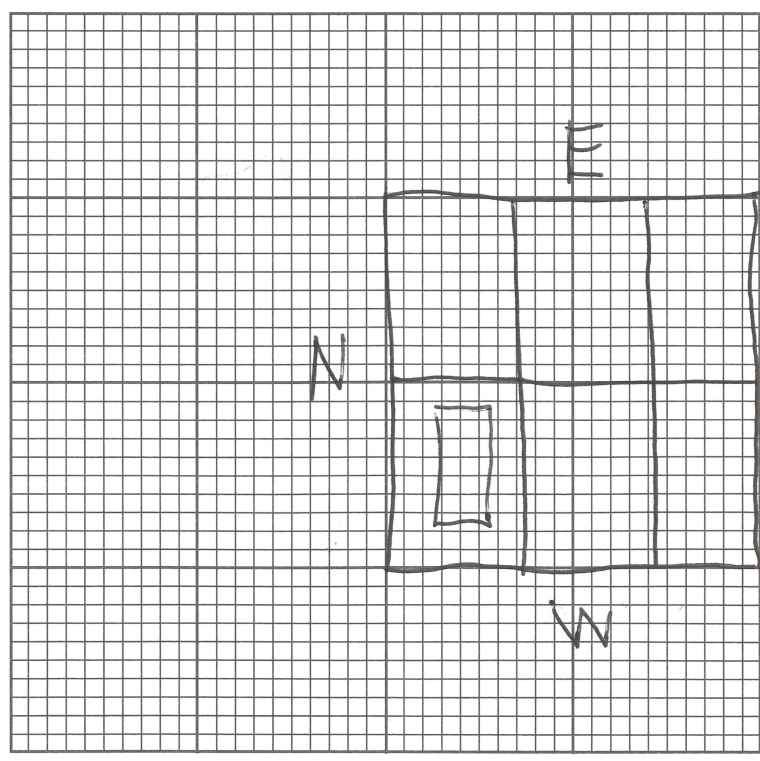

INDICATE DIRECTION BY N. S. E. OR W.

Grave No.	FULL NAME OF DECEASED	REMARKS
1	Marvel Skinner	
2		
3	2' from W lot line	
4	to edge of grave	
5		
6	2' from N lot line	
7	in W 1/2 to center	
8	of grave	
9		
10		
11	3-23-18	
12	Nishna	