

BURIAL REPORT

From Sexton to Secretary of Cemetery
(TO BE RECORDED IN CEMETERY RECORD)

Burial or Permit No. 8359

1. Place of Death Marion Pella Comfort House - Hospice of Pella
(County) (Township or City) (Facility)
2. Name: Rachel Ray Vivien Stoddard
3. Sex: Female 4. Color or Race White
5. Single, Married, Widowed or Divorced Widowed
6. Date of Birth Oct. 14, 1924 7. Age 93 Years 1 Months Days
8. Occupation: Secretary - Seed & Nursery
9. Birthplace (State or County) London, England
10. Name of Father Joseph Alfred Bernstein
11. Birthplace of Father
12. Maiden Name of Mother Dorothy Agnus Swain
13. Birthplace of Mother
14. Informant Norma Bishop 15. Address 206 E 8th St., Pella, IA 50219
16. Date of Death: November 14, 2017

Name of Doctor (or Coroner or Health Officer) Dr. Mitch Blom, DO

Address 404 Jefferson St, Pella, IA 50219

Place of Burial or Removal Rose Hill Cemetery Date of Burial: Nov. 17, 2017

19. Undertaker Nishna Valley F & C Address 405 W Thomas Ave
Shenandoah, IA 51601

Field Record of Previous Burials

These sheets to be used on the grounds to secure data which will be copied permanently in Cemetery Lot Record.

NOTE: Each small square represents a square foot of lot surface. For convenience each tenth foot is indicated by a heavy line. To make a record of previous burials, draw a diagram, with pencil, of each lot, beginning with Lot No. 1, and use a separate sheet for each lot. This can be done in the office from the plat and the owner's name and other data as to ownership secured from deed record. These blanks will then be taken to the cemetery and a record will be made from the lots, of the names of those buried and location of grave on lot. A number corresponding to name must be placed on plat to identify grave.

Description Owned Southview, Block 3, N $\frac{1}{2}$ Lot No. 16, _____ Ft.
Addition, Sub-division or Section Part of Lot Dimensions

Name of Owner Stoddard Address _____ Date Sold _____

Remarks: Concrete Vault Price, \$ _____

17

INDICATE DIRECTION BY N. S. E. OR W.

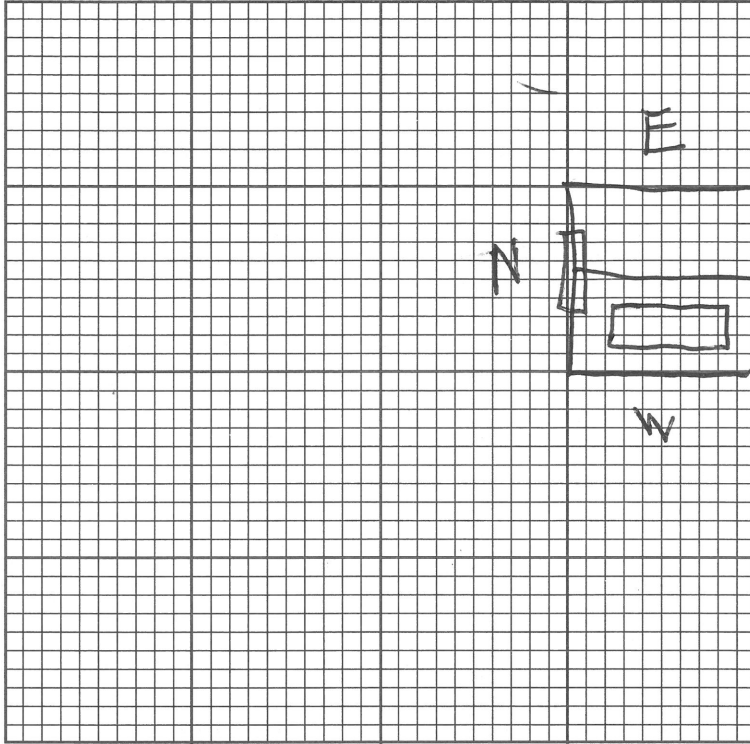

Grave No.	FULL NAME OF DECEASED	REMARKS
1	Ray V. Stoddard	
2		
3	2' from N lot line	
4	to edge of grave	
5		
6	2' from W lot line	
7	of N $\frac{1}{2}$ to center of	
8	grave.	
9		
10		
11	Nishna	
12	11/17/17	