

**BURIAL REPORT**  
From Sexton to Secretary of Cemetery  
(TO BE RECORDED IN CEMETERY RECORD)

Burial or Permit No.....

1. Place of Death Page Shenandoah Elm Heights Care Center  
(County) (Township or City) (Facility)
2. Name: Edward Dale Hobbs
3. Sex: Male 4. Color or Race White
5. Single, Married, Widowed or Divorced: Married
6. Date of Birth 02/02/1925 7. Age 92 Years 1 Months 3 Days
8. Occupation: Carpenter
9. Birthplace (State or County) Grundy County, Missouri
10. Name of Father Delbert Hobbs
11. Birthplace of Father \_\_\_\_\_
12. Maiden Name of Mother: Sylva Ratliff
13. Birthplace of Mother \_\_\_\_\_
14. Informant Mary K. Hobbs 15. Address: 401 E. Nishna Road, Shenandoah, Iowa 51601
16. Date of Death: 03/05/2017
17. Name of Doctor (or Coroner or Health Officer) Dr. Todd Isaacson 18. Address Shenandoah, Iowa
19. Place of Burial or Removal Rose Hill Cemetery 20. Date of Burial: 3/10/2017
21. Undertaker Hackett Livingston Funeral Home
22. Address 208 W. Clarinda Ave, Shenandoah, Iowa 51601

# Field Record of Previous Burials

*These sheets to be used on the grounds to secure data which will be copied permanently in Cemetery Lot Record.*

NOTE: Each small square represents a square foot of lot surface. For convenience each tenth foot is indicated by a heavy line. To make a record of previous burials, draw a diagram, with pencil, of each lot, beginning with Lot No. 1, and use a separate sheet for each lot. This can be done in the office from the plat and the owner's name and other data as to ownership secured from deed record. These blanks will then be taken to the cemetery and a record will be made from the lots, of the names of those buried and location of grave on lot. A number corresponding to name must be placed on plat to identify grave.

Description Owned SouthView, Block 5, S 1/2 W 1/2 Lot No. 79, \_\_\_\_\_ Ft.  
Addition, Sub-division or Section Part of Lot Dimensions

Name of Owner Edward Dale Hobbs Address \_\_\_\_\_ Date Sold \_\_\_\_\_

Remarks: Cremation Price, \$ \_\_\_\_\_

29

INDICATE DIRECTION BY N, S, E, OR W.

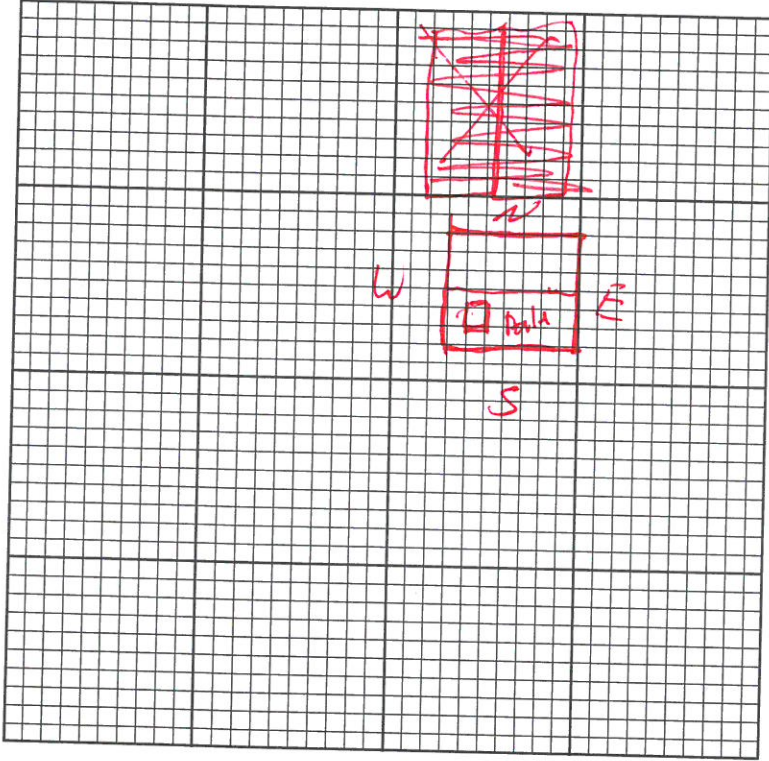

Grave No.	FULL NAME OF DECEASED	REMARKS
1	Edward Dale Hobbs	
2		
3	2' 6" From west	
4	Lot Line to west edge	
5	of Grave	
6		
7	1' 6" From south Lot Line	
8	to south edge of Grave	
9		
10		
11	Hackett	
12	march 10, 2017	