

# BURIAL REPORT

From Sexton to Secretary of Cemetery  
(TO BE RECORDED IN CEMETERY RECORD)

Burial or Permit No. ....

8407 c

1. Place of Death Page Shenandoah, IA Elm Heights Care Center  
(County) (Township or City) (Facility)
2. Name: Harley Howard Greenwalt
3. Sex: male 4. Color or Race White
5. Single, Married, Widowed or Divorced: Widowed
6. Date of Birth 05/14/1918 7. Age 100 Years  Months  Days
8. Occupation: Sign Artist
9. Birthplace (State or County) Shenandoah, IA
10. Name of Father: Howard Greenwalt
11. Birthplace of Father
12. Maiden Name of Mother: Cecil Bartles
13. Birthplace of Mother
14. Informant Ruth Dwyer 15. Address: 2 Country Club Lane, Shenandoah, IA 51601
16. Date of Death: 6/20/2018
17. Name of Doctor (or Coroner or Health Officer) Dr. Isaccson 18. Address Shenandoah, IA
19. Place of Burial or Removal Rose Hill Cemetery 20. Date of Burial: 6/26/2018
21. Undertaker Hackett Livingston Funeral Home
22. Address 208 W. Clarinda Ave. Shenandoah, Iowa 51601

250.00

# BURIAL REPORT

No. 8407c

Name: Harley Howard Greenwalt

Burial Date: 6/26/2018

Date of Death 6/20/2018

## Field Record of Previous Burials

*These sheets to be used on the grounds to secure data which will be copied permanently in Cemetery Lot Record.*

NOTE: Each small square represents a square foot of lot surface. For convenience each tenth foot is indicated by a heavy line. To make a record of previous burials, draw a diagram, with pencil, of each lot, beginning with Lot No. 1, and use a separate sheet for each lot. This can be done in the office from the plat and the owner's name and other data as to ownership secured from deed record. These blanks will then be taken to the cemetery and a record will be made from the lots, of the names of those buried and location of grave on lot. A number corresponding to name must be placed on plat to identify grave.

Description Owned South view, Block 7, W $\frac{1}{2}$  Lot No. 3, \_\_\_\_\_ Ft.  
Addition, Sub-division or Section Part of Lot Dimensions

Name of Owner Greenwalt Address \_\_\_\_\_ Date Sold \_\_\_\_\_

Remarks: cremation Price, \$ \_\_\_\_\_

29

INDICATE DIRECTION BY N. S. E. OR W.

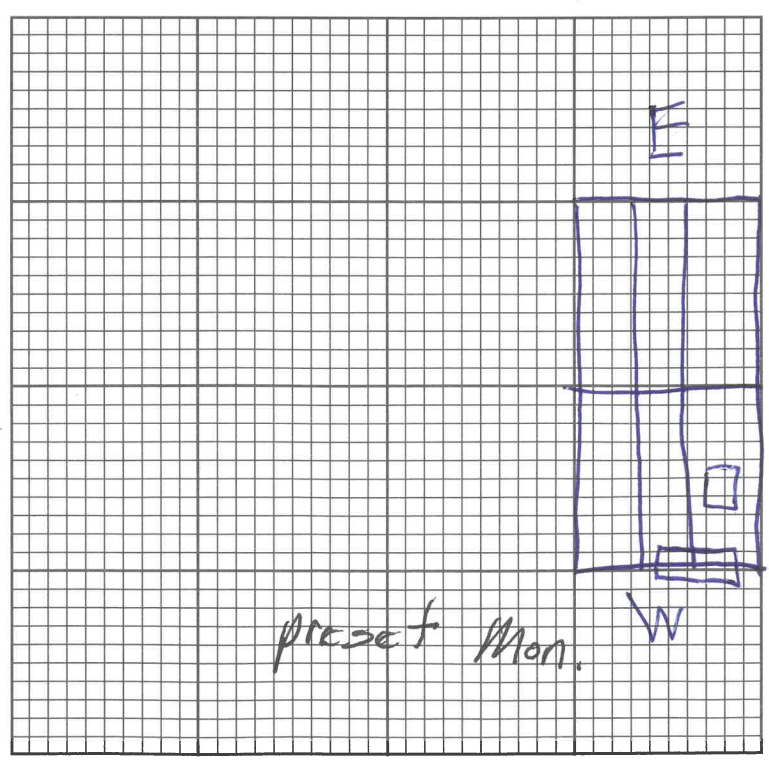

Grave No.	FULL NAME OF DECEASED	REMARKS
1	Harley Greenwalt	
2		
3	2' from W lot line	
4	to edge of grave	
5		
6	2' from the S lot	
7	line in W $\frac{1}{2}$ to center	
8	of grave.	
9		
10	Hackett	
11	6-26-18	
12		