

**BURIAL REPORT**  
From Sexton to Secretary of Cemetery  
(TO BE RECORDED IN CEMETERY RECORD)

Burial or Permit No. 8506

1. Place of Death Page Shenandoah, IA Elm Heights Care Center  
(County) (Township or City) (Facility)
2. Name: D.B. Mullins
3. Sex: male 4. Color or Race Caucasian
5. Single, Married, Widowed or divorced: Widowed
6. Date of Birth 11/17/1929 7. Age 90 Years    Months    Days
8. Occupation: Banker
9. Birthplace (State or County) Watson, MO
10. Name of Father: Alex Mullins
11. Birthplace of Father
12. Maiden Name of Mother: Rebeca Bailey
13. Birthplace of Mother
14. Informant: Tery Dickerson Address: 306 W Thomas; Shenandoah, IA 51601
16. Date of Death: 12/16/2019
17. Name of Doctor (or Coroner or Health Officer) Dr. Kriesfeld
19. Place of Burial or Removal Rose Hill Cemetery 20. Date of Burial: 12/20/2019
21. Undertaker Hackett Livingston Funeral Home
22. Address 208 W. Clarinda Ave. Shenandoah, Iowa 51601

250.

# BURIAL REPORT

No. 8506

Name: D.B. Mullins

Burial Date: 12/20/2019

Date of Death 12/16/2019

## Field Record of Previous Burials

*These sheets to be used on the grounds to secure data which will be copied permanently in Cemetery Lot Record.*

NOTE: Each small square represents a square foot of lot surface. For convenience each tenth foot is indicated by a heavy line. To make a record of previous burials, draw a diagram, with pencil, of each lot, beginning with Lot No. 1, and use a separate sheet for each lot. This can be done in the office from the plat and the owner's name and other data as to ownership secured from deed record. These blanks will then be taken to the cemetery and a record will be made from the lots, of the names of those buried and location of grave on lot. A number corresponding to name must be placed on plat to identify grave.

Description Owned Southview, Block 8, N $\frac{1}{2}$  Part of Lot No. 3, \_\_\_\_\_ Ft.

Name of Owner Mullins Address \_\_\_\_\_ Date Sold 1993

Remarks: cremation Price, \$ \_\_\_\_\_

Grave No.	FULL NAME OF DECEASED	REMARKS
1	D.B. Mullins	
2		
3	2' from N lot line	
4	to edge of grave.	
5		
6	2' from E lot line	
7	in N $\frac{1}{2}$ to center	
8	of grave.	
9		
10	Hackett	
11	12-20-19	
12		

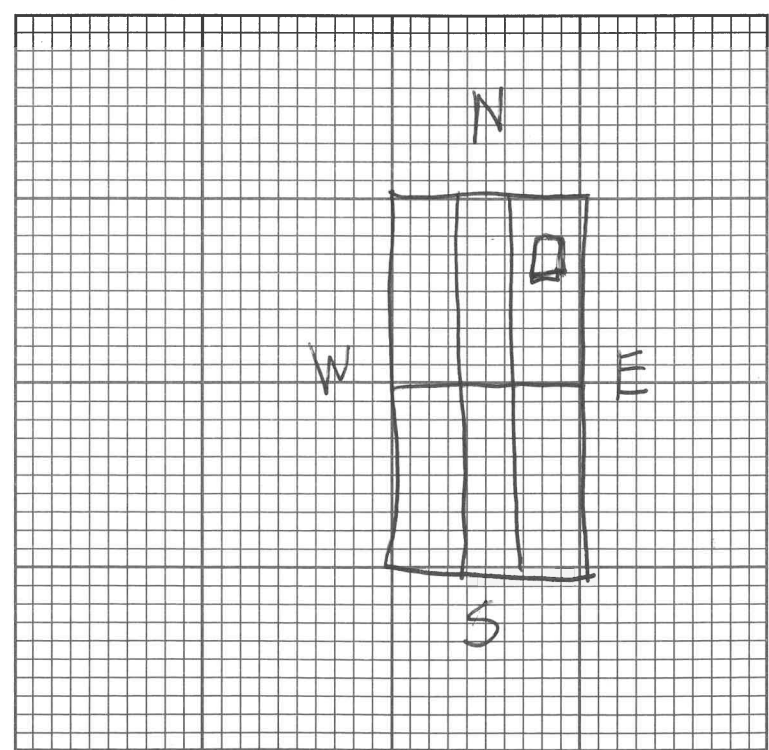

29

INDICATE DIRECTION BY N. S. E. OR W.