

BURIAL REPORT
From Sexton to Secretary of Cemetery
(TO BE RECORDED IN CEMETERY RECORD)

Burial or Permit No. 8299.....

1. Place of Death Page Shenandoah Windsor Manor Assisted Living
(County) (Township or City) (Facility)
2. Name: Doris Jean Cooper
3. Sex: Female 4. Color or Race White
5. Single, Married, Widowed or Divorced: Married
6. Date of Birth July 8, 1926 7. Age 90 Years 5 Months 13 Days
8. Occupation: Public School Cook
9. Birthplace (State or County) Farragut, Iowa
10. Name of Father John Mascher
11. Birthplace of Father _____
12. Maiden Name of Mother: Ellen Carlburg
13. Birthplace of Mother _____
14. Informant Raymond "Bud" Cooper 15. Address: 601 Harrison St. #207, Shenandoah, Iowa 51601
16. Date of Death: 11/21/2016
17. Name of Doctor (or Coroner or Health Officer) Dr. Todd Isaacson 18. Address Shenandoah, IA
19. Place of Burial or Removal Rose Hill Cemetery 20. Date of Burial: 11/25/2016
21. Undertaker Hackett Livingston Funeral Home
22. Address 208 W. Clarinda Ave, Shenandoah, Iowa 51601

BURIAL REPORT

No. 8899

Name: Doris Jean Cooper

Burial Date: 11/25/2016

Date of Death 11/21/2016

Field Record of Previous Burials

Corrected

These sheets to be used on the grounds to secure data which will be copied permanently in Cemetery Lot Record.

NOTE: Each small square represents a square foot of lot surface. For convenience each tenth foot is indicated by a heavy line. To make a record of previous burials, draw a diagram, with pencil, of each lot, beginning with Lot No. 1, and use a separate sheet for each lot. This can be done in the office from the plat and the owner's name and other data as to ownership secured from deed record. These blanks will then be taken to the cemetery and a record will be made from the lots, of the names of those buried and location of grave on lot. A number corresponding to name must be placed on plat to identify grave.

Description Owned Southview, Block 8, S 1/2 Part of Lot No. 97, _____ Ft.

Name of Owner Ray Cooper Address _____ Date Sold _____

Remarks: Concrete Vault Price, \$ _____

INDICATE DIRECTION BY N. S. E. OR W.

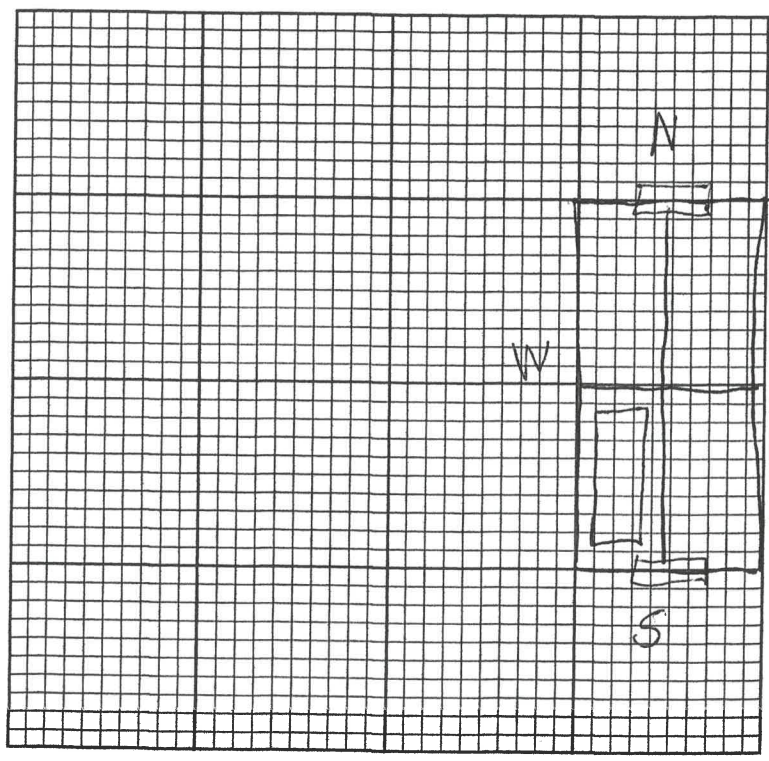

Grave No.	FULL NAME OF DECEASED	REMARKS
1	<u>Doris J. Cooper</u>	
2		
3	<u>2' from W lot line in</u>	
4	<u>S 1/2 to center of grave</u>	
5		
6	<u>2' 6" from S lot line</u>	
7	<u>to edge of grave</u>	
8		
9		
10		
11	<u>Burial 11/25/2016</u>	
12	<u>Hackett</u>	