

BURIAL REPORT
From Sexton to Secretary of Cemetery
(TO BE RECORDED IN CEMETERY RECORD)

Burial or Permit No. _____

8308
burial 1/28/2017 - Hackett

1. Place of Death Page Shenandoah, IA Garden View Care Center
(County) (Township or City) (Facility)
2. Name: Mary Lou Holdridge
3. Sex: Female 4. Color or Race White
5. Single, Married, Widowed or Divorced: Widowed
6. Date of Birth 12/20/1928 7. Age 88 Years 0 Months 25 Days
8. Occupation: Assistant Librarian
9. Birthplace (State or County) Rock Port, MO
10. Name of Father Walter Gutsch
11. Birthplace of Father _____
12. Maiden Name of Mother: Lois Wood
13. Birthplace of Mother _____
14. Informant Robert Holdridge, Jr. 15. Address: 107 W. Thomas Ave. Shenandoah, Iowa 51601
16. Date of Death: 01/14/2017
17. Name of Doctor (or Coroner or Health Officer) Dr. Todd Isaacson 18. Address Shenandoah, IA
19. Place of Burial or Removal Rose Hill Cemetery 20. Date of Burial: 1/28/2017
21. Undertaker Hackett Livingston Funeral Home
22. Address 208 W. Clarinda Ave, Shenandoah, Iowa 51601

Field Record of Previous Burials

These sheets to be used on the grounds to secure data which will be copied permanently in Cemetery Lot Record.

NOTE: Each small square represents a square foot of lot surface. For convenience each tenth foot is indicated by a heavy line. To make a record of previous burials, draw a diagram, with pencil, of each lot, beginning with Lot No. 1, and use a separate sheet for each lot. This can be done in the office from the plat and the owner's name and other data as to ownership secured from deed record. These blanks will then be taken to the cemetery and a record will be made from the lots, of the names of those buried and location of grave on lot. A number corresponding to name must be placed on plat to identify grave.

Description Owned Memorial, Block 4, 5 1/2 Lot No. 36, _____ Ft.
Addition, Sub-division or Section Part of Lot Dimensions

Name of Owner Holdridge Address _____ Date Sold 4/1993

Remarks: cremation 3 spaces Price, \$ _____

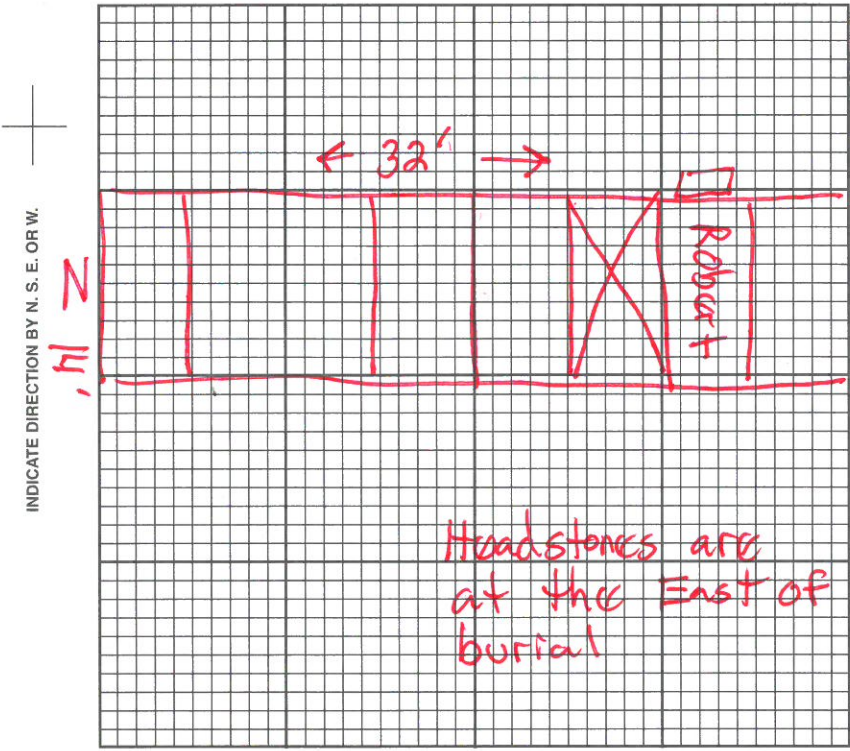

Grave No.	FULL NAME OF DECEASED	REMARKS
1	Mary Lou Holdridge	
2		
3	6' from S lot line	
4	to center of grave	
5	2'6" from E lot	
6	line to edge of	
7	grave	
8		
9		
10		
11	Hackett	
12	Burial 1/28/2017	